

Cam switch JPDM, JPUM



- Small plastic box with dimensions of 82x82x62 mm, or 82x82x83 mm with IP65 protection
- Box design for cam switch S6-10J, with 2 chambers with low lid, S6-10J with 4 chambers with higher lid
- Box design for cam switch S16-25J with 3 chambers with higher lid
- In the basic version offered as type JPD (with front panel)
- Possibility of other designs: JPU (with locking lever), JPZ (with FAB lock)
- Comply with STN EN 60 947-3 (EN 60947-3, IEC 60 947-3, ČSN 60 947-3), STN EN 60 204-1
- Switches have access to terminals with screwdrivers at an angle of 45° and also improved readability of terminal markings on the tilted surface
- Switching angle 30°, 45°, 60°, 90°



Valid from 12.05.2025

SEZ Kropachy a.s. • Hornádska 1 • 053 42 Kropachy • Slovak Republic

tel.: +421 53 4189 144 • www.sez-kropachy.sk • e-mail: yes@sez-kropachy.sk



Cam switch JPDM, JPUM



Switch type	S6J	S10J	S16J	S25J
Rated insulation voltage U_i , V	500	500	690	690
Rated impulse withstand voltage U_{imp} , kV	4	4	4	4
Rated thermal current I_{th} , A	6	10	20	25
Rated operational current I AC-21A resistive load AC-1- slightly inductive load	6	10	16	25
Rated operational power, kW / rated operational current I_{th} , A				
AC-3 motors with squirrel-cage rotor: Starting, running				
1 phase 220-240V	0,9/5,1	1,5/8,5	1,7/9,6	2,6/14,7
3 phase 220-240V	1,5	2,5	3	4,5
380-440 V	2,5/4,5	3,5/6,3	4/7,2	7,5/13,5
500 V	2,5	3,5	4	7,5
AC-23A switching of motor and highly inductive loads				
1 phase 220-240V	1/5,5	1,7/9,6	2,3/13	3/17
3 phase 220-240V	1,8	3	4	5,5
380-440 V	3,3/6	5,5/10	7,5/13,5	11/9,8
500 V	3,3	5,5	7,5	11
Rated operational current I, A				
Direct current 24V	6/4	10/8	16/8	25/8
(switching with one contact) 48V	3,7/2	6/4	6/4	6/4
DC-21A/DC22A 110V	0,7/0,2	7/0,3	1/0,3	1/0,3
(resistive load / direct current motors) 220V	0,2/0,1	0,3/0,2	0,3/0,2	0,3/0,2
Rated conditional short-circuit current kA	3	4	5	5
with gG fuse, A	6	10	16	25
Rated short-time withstand current - 1 sec I_{sw} , A	160	200	220	500
Short-circuit making capacity I_{sm} , A	320	400	400	500
Mechanical durability (cycles)	106	106	106	106
Range of connecting conductors mm ²	0,5-2,5	0,5-2,5	1-4	1,5-4
Connecting screw	M3	M3	M4	M4
Operating shaft (mm/mm)	5x5	5x5	5x5	5x5

JPU design with low and high lid

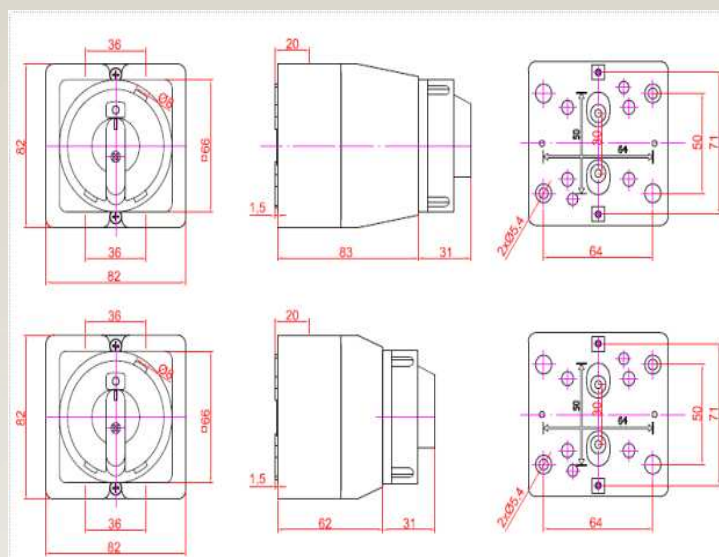

JPD design with low and high lid

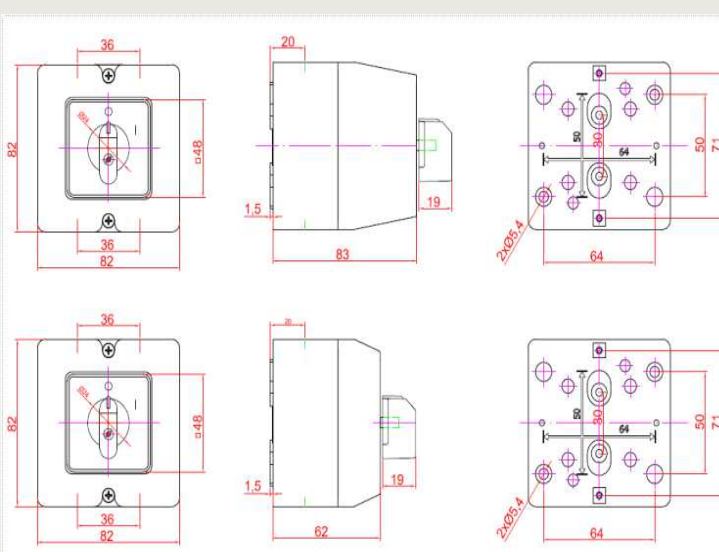

Valid from 12.05.2025

SEZ Kropachy a.s. • Hornádska 1 • 053 42 Kropachy • Slovak Republic

tel.: +421 53 4189 144 • www.sez-kropachy.sk • e-mail: yes@sez-kropachy.sk

